

# The **TLG** INSIDER

THE LANE GROUP QUARTERLY NEWSLETTER

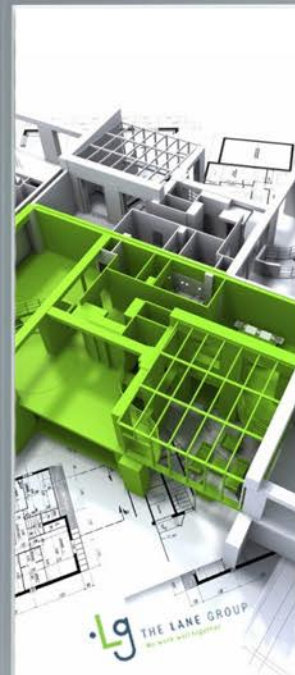

engineers | architects | surveyors | environmental specialists

## IN THIS ISSUE

### LUNCH AND LEARN SERIES page 1

Designed to educate our clients while providing continuing education credits close to home

### IN THE COMMUNITY page 2

TLG strives to give back to the communities in which we work and live

### NEW FACES page 2

TLG is pleased to announce new hires in various disciplines

### FEATURED EMPLOYEE page 3

Get to know "The Group"

### FEATURED PROJECT page 3

Wythe County Appalachian Expo Center Development

## LUNCH & LEARN SERIES

The Lane Group (TLG) is proud to announce the implementation of the Lunch and Learn series as an annual program.

TLG's mission is to further educate local government and municipal employees in the latest products, guidelines, and procedures without having the expense of traveling across the state - while also earning continuing education credits.

Three Lunch and Learn events will be held each year (Spring, Summer and Fall). These events will be held throughout our service area.

For more information regarding TLG's Lunch and Learn series or to suggest a potential topic, please contact Chris Mullins at 276.523.3771 or [cmullins@thelanegroupinc.com](mailto:cmullins@thelanegroupinc.com)



## IN THE COMMUNITY

On August 16th, TLG hosted the Pigskin Picks Football Radio Show at WAXM 93.5 in Norton, Virginia. Pigskin Picks is a show focused on area high school football in Southwest Virginia and airs every Thursday at 8:00 p.m. and re-airs on Friday at 5:30 p.m. during football season.

TLG employees prepared a cook-out style meal for area coaches and show personnel. As an added bonus, we had the opportunity to feed the City of Norton's Police Officers that were on duty as a small token of our appreciation for their service.

TLG is a proud supporter of youth and high school athletics.



## NEW FACES AT TLG

TLG Board of Directors is pleased to announce the addition of four employees to the firm.

**Mr. Douglas Williams, AIA** holds over 25 years of experience in architecture. Doug holds a bachelor's degree in Architecture from Virginia Tech and professional licensure in the states of Virginia and North Carolina. Doug owned and operated Douglas Williams Architecture in Galax, Virginia for nearly 17 years prior to joining TLG.

**Ms. Haley Robinson** is a recent graduate of Bluefield State College with a bachelor's degree in Architectural Technology and Engineering Management. Haley hails from Princeton, West Virginia.

**Mr. Aaron Fleenor** is a recent graduate of East Tennessee State University with a bachelor's degree in Surveying and Mapping. Aaron is a level three certified boundary land surveyor and recently obtained his Licensed-Surveyor-in-Training (LSIT) certification.

**Mr. Matt Felts, EIT** is a recent graduate of the University of Virginia with a bachelor's degree in Civil and Environmental Engineering. Matt holds a Virginia Engineer-in-Training certificate.



Douglas Williams, AIA  
Lead Architect



Matt Felts, EIT  
Staff Engineer



Haley Robinson  
Architecture



Aaron Fleenor, LSIT  
Surveying



## FEATURED EMPLOYEE

TLG wants you to “get to know the group”. In this issue, we feature Mr. Matthew R. Lane, PE. Matthew obtained a bachelor’s degree in Civil Engineering from Virginia Tech in 1995 and a master’s degree in 1997. Matthew is a registered professional engineer in the states of Virginia, Tennessee and North Carolina and currently serves as President of TLG.

Matthew resides in Abingdon, Virginia with his wife April and two sons, Jonas and Jackson. Matthew is very active in the community by volunteering as a youth sports coach for both football and baseball.

Along with his father, Bobby Lane, Matthew is the co-founder of The Lane Group. TLG was founded in 1996 in Kingsport, Tennessee and shortly relocated to Big Stone Gap, Virginia.

Matthew’s contact information:

310 West Valley Street | Abingdon, Virginia 24210

276.206.8571 or [mlane@thelanegroupinc.com](mailto:mlane@thelanegroupinc.com)



## FEATURED PROJECT

**WYTHE COUNTY APPALACHIAN EXPO CENTER DEVELOPMENT PROJECT:** TLG is very pleased with the opportunity to provide professional engineering and architectural services for the new Expo Center project. This state-of-the-art facility will be located in Wytheville Virginia along Interstate 81 near Exit 77. Phase I of the project will consist of an 84,000 square foot expo facility, infrastructure, access road, and parking areas.

Phase II will consist of additional access roads, parking areas, an outdoor riding arena, barn facilities, and sports fields.

The Expo Center facility will host events such as concerts, rodeos, etc. Phase I is scheduled for construction in the Spring of 2017.

Client: Wythe County Board of Supervisors | Wytheville, Virginia.

